

Product Features

- ISO/IEC 19794-6:2011 standard compliant images
- Dual iris capture takes ~2 seconds to deliver 8-bit bitmaps ready for enrollment
- Operating range = 300 +/- 5 mm
- 810nm IR light source with dual band IR wavelength capability
- Resolution = 60% @ 4lp/mm, ≥ 16pixels/mm
- Power Input = 5VDC, power consumption = 4.25Watts
- PC Interface = USB3.0
- Product Package: Fully enclosed Iris Camera or OEM Iris camera module
- API available for integration with any biometric SDK for template creation
- Eye safety certified - IEC 62471

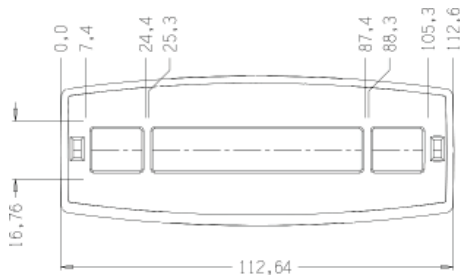

Technical Specifications

Electrical	ID1-24M5.0CAM
Image Sensor	1/2.5" CMOS
Supported Resolution	2592 x 600 pixels
Pixel Size	2.2µm x 2.2µm
Shutter Mode	Rolling
Responsively	1.4 V/lux-sec
Dynamic Range	70.1dB
Control Communication	Camera control via UVC
Video Output	USB 3.0
Signal to Noise Ratio	> 38dB
Supplied Voltage	5VDC via USB bus
Power Consumption	4.25W
Scanning System	Progressive
Frame Rate	30fps
Image Flip	Default off
Mirror Mode	Default on
AGC Control	Auto (default)

Environmental	
Operating Temperature	-10°C ~ 75°C (14°F ~ 167°F)
Operating Humidity	30% ~ 90%
Storage Temperature	-30°C ~ 80°C (-22°F ~ 176°F)
Storage Humidity	85%

Mechanical	
Dimensions W x H x D	120mm x 60mm x 60mm (4.72" x 2.36" x 2.36") visor only
Weight	50g (1.76oz)
Lens Mounts	Metal M-12 Board
Lens Focal	f=12mm, F=4.0, FOV (H)=26.72°
Lens Filter	Cold mirror, transmission > 700nm

Software		
Viewer (included) SFT-20088	<ul style="list-style-type: none"> • UVC compliant • DirectX /DirectShow compliant 	
SDK (optional)	Complete software development kit and support for OEMs	
Minimum System Requirements		
Hardware	iCore i5 or equivalent	8GB RAM, Microsoft .NET Framework ver. 3.5, Dedicated USB3.0 port
Software	Windows 7	32 bit, and 64 bit

Accessories		
Included		1/4 20 mount for easy mounting capability
Optional	60C1183	6ft. USB 3.0 type A cable to USB micro B (Blue)

Safety Standards	
	RoHS, ISO/IEC 19794-6:2011, IEC 62471

Ordering Information	
ID1-24M5.0CAM	Iris scanner
ID1-24M5.0CAMP	Iris scanner, Photo ID camera
ID1-24M5.0CAMP-P	Iris scanner, Photo ID camera, flash unit
ID1-24M5.0CAMP-SYS	Iris scanner, Photo ID camera, flash unit, stand
24B505MPUSB3-IRIS	OEM option