

Product Features

- NTSC/PAL auto detect
- High resolution (1280 x 1024 pixels)
- Inputs/outputs:
 - 1 BNC composite video
- Auto termination (75 Ohms)
- VESA standard bracket (75mm/100mm) and desktop mount
- Easy OSD menu user interface
- Anti-glare panel
- 3D comb filter
- Anti-glare panel
- Built-in speaker
- PIP control
- IR remote control

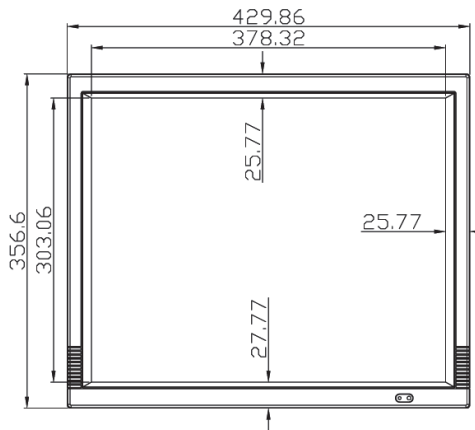

Back Panel

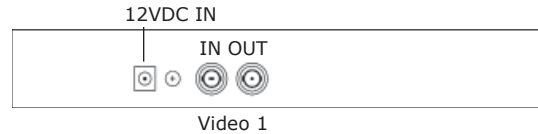

Technical Specifications

Electrical	45M19H-1FW
Operating System	NTSC/ PAL auto select
Picture Size	19" diagonal
Resolution (H x V)	1280 x 1024 pixels (SXGA)
Viewable Area	376.3mm x 301mm
Screen Ratio	4:3
Display Colors	16.7M
Brightness	300 nits
Contrast Ratio	800:1
Response Time	1.3/3.7ms
Backlight	CCFL
Video Input	1 CH 1Vp-p composite BNC video at 75 Ohms (loop thru)
Audio Input	1 Audio (RCA) L/R 1 PC Audio (Phone Jack)
Video Angle	Left 88°, Right 88°, Up 85°, Down 85°
Lamp Life-time	40,000 hrs
Power Source	12VDC, 100~240V AC 50Hz/ 60Hz
Power Consumption	33W/ 5A

Environmental

Operating Temperature	-10°C ~ 50°C (14°F ~ 122°F)
Operating Humidity	20% - 85% R.H.
Storage Temperature	-20°C ~ 60°C (-4°F ~ 160°F)

Mechanical

Dimensions W x H x D	429.86mm x 356.6mm x 66.7mm (16.92" x 14.03" x 2.62")
Weight	5.54 kgs (12.21 lbs)

Accessories

Included	User manual
	Power cord
	12VDC power adapter
	Bracket: VESA 100 standard
	Remote control