

Product Features

- Sizes available
 - 15mm x 15mm board camera
 - 17mm x 17mm housed camera
- Low power 1/3" CMOS color sensor
- 1080p @30pfs/60Hz or 25fps/50Hz
Please specify in model ordering
 - T- TVI coaxial output to 500m (1,600ft)
 - A- AHD coaxial output to 500m (1,600ft)*
- Computer controllable via I²C
- Wide input voltage 4-16V
- Lens mount compatibility
 - M-12 mount

Camera sizes are equivalent to a dime!

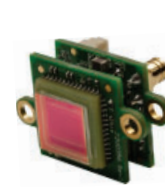

24C46XX
15mm x 13mm Double Board Camera Shown



24C465X
18mm x 16mm Housed Camera with Optional Lens Shown

Pinhole Mount
24C462A/T

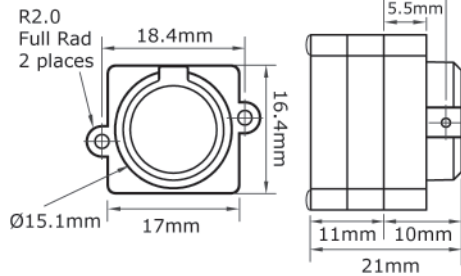

No Housing
24C46XA/T

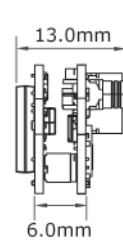

M-12 Mount
24C465A/T

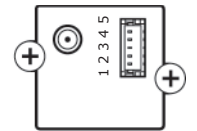
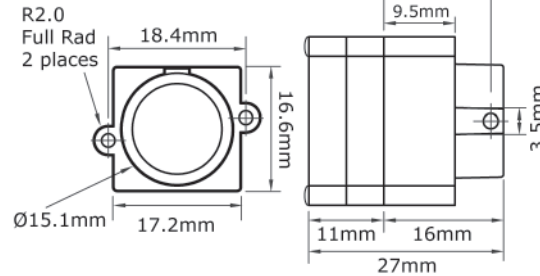

Power and I²C
1 PWR (4-16V)
2 GND
3 GPIO
4 I²C SDA
5 I²C SCL

Technical Specifications

Electrical	24C46 Series
Image Sensor	1/3" CMOS 2.1MP
Active Pixels	1920 x 1080
Aspect Ratio	16:9
Pixel Size / Image Size	2.8µm x 2.8µm / 5.42mm x 3.068mm
Scanning System	Progressive
Resolution / Frame Rate	2.1 MP (1920x1080) 30/25 fps
Pixel clock rate	74.25MHz
Sensitivity	< 0.5 Lux 3.6 V/lux-sec
Signal To Noise Ratio	42 dB (AGC On)
Gamma	0.45 default
Gain	Automatic: 1 - 64x / Manual: 1 - 128x
Synchronization	Internal
Dynamic range	60.0 dB
Signal to Noise ratio	42.0 dB
Automatic Gain Control	Automatic / manual
Mirror / Flip	Horizontal & Vertical On/Off
Video output interfaces	Coaxial: TVI or AHD
Supplied Voltage	4.0 - 16.0 V
Current drawn @5V	Typical: 180mA Max: 200mA
Current drawn @12V	Typical: 80mA Max: 95mA
Current drawn @15V	Typical: 65mA Max: 75mA
Power consumption	0.9W (max 1.1W)

*Twisted Pair is optional connector modification

Communication

Interface	Serial I ² C
HD Transmission Distance	
TVI	>500m (1,600ft)
AHD	>500m (1,600ft)

Mechanical

Dimensions WxHxD (w/ connector)	24C46X	15mm x 15mm x 13mm (0.59" x 0.59" x 0.26")
	24C465 M-12 mount	17.2mm x 16.6mm x 27mm (0.67" x 0.65" x 1.06")
Lens Mounts Example: To select an M-12 Board Mount Change 24C46X to 24C465	Replace "X" in model number with desired lens mount: X: no housing 2: M-12 Pinhole lens mount 5: M-12 lens mount See our lenses at www.videologyinc.com/lenses	
Connectors	Analog TVI/AHD Coaxial	MMCX 50Ω
	Power/GPIO 5-pin	Würth WR-WTB 1.0mm (665 305 124 022) JST SH 1.0mm (BM05B-SRSS-TB)

Environmental

Operating Temp.	-30°C ~ 85°C (-22°F ~ 185°F)
Storage Temp.	-40°C ~ 105°C (-40°F ~ 221°F)
Operating Humidity	20% ~ 90% RH
Storage Humidity	94% RH

Optional Models

24C46XAN / P	AHD coaxial output to 500m (1,600ft) no housing
24C46XTN / P	TVI coaxial output to 500m (1,600ft) no housing
24C462AN / P	AHD coaxial output to 500m (1,600ft) Pinhole mount
24C462TN / P	TVI coaxial output to 500m (1,600ft) Pinhole mount
24C465AN / P	AHD coaxial output to 500m (1,600ft) M-12 mount
24C465TN / P	TVI coaxial output to 500m (1,600ft) M-12 mount
N = NTSC, P = PAL	