

Technical Specifications

Sensing Area	1/3"	
Focal Length	3.7mm	
Aperture	F2.0	
Back Focal Length	3.3mm	
Field of View (D x H x V)	90.0° x 57.8° x 48.6°	
Operation	Iris	Fixed
	Focus	Manual
Distortion	-38%	
Minimum Object Distance	40cm	
Mount	M-12	
Dimensions (Ø x L)	Ø 12mm x 7.3mm	
Weight	2.5g	

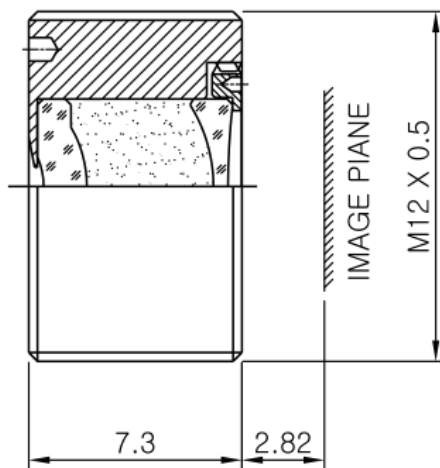

Tolerance : ±0.4mm