

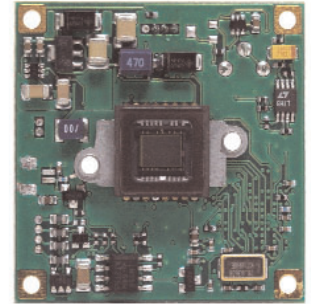

### Technical Specifications - All Models

- **1/3" CCD**  
1/3" IL CCD (Color)/ 1/3" Sony Ex-View® CCD (B&W)
- **Picture Elements**  
768 x 492 (NTSC) / 752 x 582 (PAL)
- **Signal To Noise Ratio**  
>48dB (AGC Off)
- **Gamma 0.45**  
0.45 (1.0 Selectable Via Software)
- **Internal Synchronization**
- **Internal Scan Mode**
- **Contour Enhancement On**
- **Electronic Iris**
- **Power Supply 12VDC**  
(+10%/-20%)  
Power Consumption <1.0W



20D10X (Actual Size)  
38mm x 38mm

### Technical Specifications - Model Specific Color

20D10X / 21D10X	High Resolution (38 x 38mm)
Resolution	480 TVL
Sensitivity	0.5 Lux (50 IRE) f1.2 3200°K
Backlight Compensation	On (off via jumper)
White Balance	AWB
Iris	DC auto iris
Video output	Composite 1Vp-p CVBS (75 ohms) 20/21D10XB - Balanced Video Output 20/21D10XA - audio option

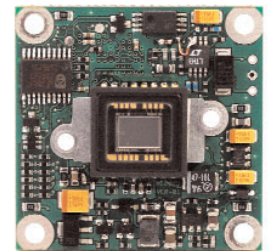

20D20X / 20D35X  
(Actual Size) 32mm x 32mm

20D20X / 21D20X	High Resolution (32 x 32mm)
Resolution	480 TVL
Sensitivity	0.5 Lux (50 IRE) f1.2 3200°K
Backlight Compensation	On (off via jumper)
White Balance	AWB
Video output	Composite 1Vp-p CVBS (75 ohms) 20/21D20XB - Balanced Video Output

### B&W

20D35X / 21D35X	High Resolution (32 x 32mm)
Resolution	570 TVL, Sony Ex-View®
Sensitivity	<0.005 Lux (50 IRE) f1.2 3200°K
Backlight Compensation	On (off via jumper)
Video output	Composite 1Vp-p CVBS (75 ohms)

20D35XB / 21D35XB	High Resolution (32 x 32mm) Balanced Video & 8-pin Connector
Resolution	570 TVL, Sony Ex-View®
Sensitivity	<0.005 Lux (50 IRE) f1.2 3200°K
Backlight Compensation	On (off via grounding pin 8)
Video output	Balanced video output @ 100 ohms
I <sup>2</sup> C Control	Shutter, Gain, Non-interlaced, Gamma, Mirror Mode

20D35XO / 21D35XO	High Resolution (32 x 32mm) Aerospace Grade & 8-pin Connector
Resolution	570 TVL, Sony Ex-View®
Sensitivity	<0.005 Lux (50 IRE) f1.2 3200°K, lens transmission 80%, scene reflection 75%
Backlight Compensation	Default on (selectable via connector interface)
Video output	Composite 1Vp-p (75 ohms)
Grounding	DC or chassis grounding option (default isolated)

### Lens Mount Options

Replace "X" in model number with desired lens mount option:

Lens mounts	8	= Metal CS
	5	= Metal M-12 board
	2	= Metal M-12 pinhole

For example: change 20D10X to 20D105 to select an M-12 Board Mount.

Metal Pinhole  
M-12 Mount

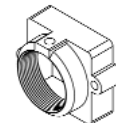

Metal M-12  
Board Mount

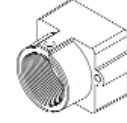

Metal CS  
Board Mount

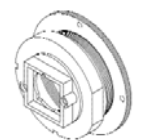

### Environmental

Operating Temperature	-15° C ~ 55° C (5° F ~ 131° F)
Storage Temperature	-30° C ~ 80° C (-22° F ~ 176° F)
Operating Humidity	20 to 93% RH
Storage Humidity	Up to 98% RH
Lifetime	MTBF >150000 hours
Packaging	Metalized, conductive bags

Warning: Avoid aiming the camera at the sun or other extremely bright lights. The CCD image sensor may be damaged if exposed to very bright objects.

See Reverse For 20K1XXUSB Series  
All data subject to change without notice.