

Product Features

- Progressive scan, 1.3 megapixel CMOS sensor (square pixels)
- Sensor is optically centered within lens mount holes
- Streaming video or single frame capture via hardware/software
- Triggerable instantaneous snap shots
- 24fps at full 1280 x 1024 resolution uncompressed video
- Simplified cabling - video, power & full camera control over a single USB cable
- Extended integration time (>0.5 sec.)
- Complete SDK available

Software

- USB 2.0 viewer software and Microsoft Digitally Certified WDM Device Drivers for 32bit and 64bit Windows operating systems
- DirectX/DirectShow compliant
- TWAIN compliant
- **Linux driver available**

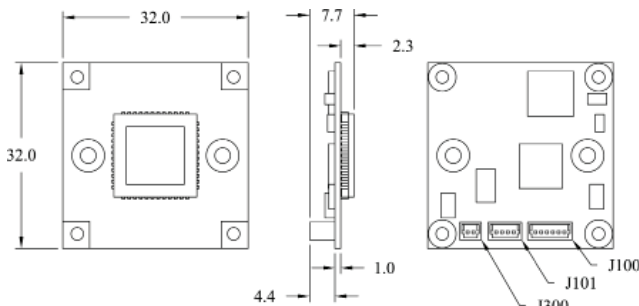
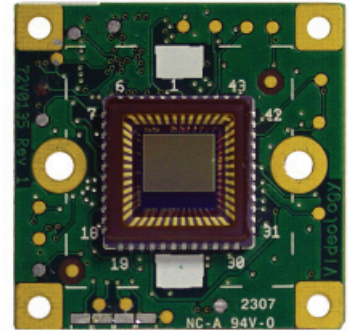

J100
1 +5V
2 D -
3 D +
4 GND
5 GND
6 GND

J101
<i>Optional</i>
1 +5.3V
2 GPIO 0
3 GPIO 1
4 GND

J300
1 Trigger
2 GND

Mechanical

Dimensions W x H x D	32mm x 32mm x 7.7mm (1.26" x 1.26" x 0.3")	
Weight	<100g (3.5oz)	
Lens Mounts	Replace "X" in model number with desired lens mount option:	
Example: change 24B1.3XUSB-C to 24B1.35USB-C to select a M-12 Board Mount.	5 = M-12 Board	8 = CS Board
Lenses (Recommended)	32SJ0818LD	8mm f1.8 M-12
	30SJ0818LD	8mm f1.8 CS
Connectors	USB board connector (6 pin power and data)	

Technical Specifications

Electrical	24B1.3XUSB-C
Image Sensor	1/2" CMOS 6.8mm x 5.4mm array
Active Pixels (HxV)	1280 x 1024, 5.2um square pixels
Frame Rate	24 fps at 1280 x 1024 un-compressed 30fps at 640 x 480 un-compressed
Sensitivity	<1.0 Lux
Signal To Noise Ratio	> 45dB
Gain Control	Manual gain selectable via software
Synchronization	Internal (X-tal controlled)
Shutter Mode	Electronic rolling shutter
Shutter Speed	Selectable via software (1/2 - 1/5000 sec.)
Scan Mode	Progressive scan
Control Communication	Camera control via USB bus
Mirror Mode	Selectable via software
Dynamic Range	68 db
Video Output	USB 2.0 (not USB 1.1 compliant)
Power Supply	5VDC via USB bus
Power Consumption	<110mA, <0.6W
Still Capture	Via hardware or software Streaming or single frame

Software

<i>Viewer (included)</i> SFT-07019	<ul style="list-style-type: none"> • WDM device drivers • DirectX/DirectShow compliant • TWAIN compliant (requires driver installation)
<i>SDK (optional)</i> SFT-07019-SDK	Complete software development kit and support for OEMs
Recommended System Requirements	
Hardware	Pentium IV 2.3GHz +, 1GB hard drive, Intel USB 2.0 Host controller
Software	Windows 7 32 bit and 64 bit Windows Vista 32 bit and 64 bit Windows XP Service pack 2 +, DirectX 9.0c or above

Accessories

Optional USB 2.0 Cable	60C1062	8 ft. (2.4384m)
	60C1062-1	40 in. (1.016m)
	60C1062-2	12 in. (304.8mm)
	60C1062-3	6 in. (152.4mm)
	60C1062-4	15 ft. (4.572m)

Complementary Models

24B1.3XUSB-L	48mm x 32mm board with USB mini B connector (minimum quantity required)
--------------	---

Standards

	RoHS
--	------

Environmental

Operating Temperature	-15°C ~ 55°C (5° F ~ 131° F)
Storage Temperature	-25° C ~ 70° C (-13° F ~ 158° F)
Operating Humidity	20 to 93%RH, non-condensing
Storage Humidity	Max. 98% RH
Packaging	ESD safe package

